

APPROACH OF RWY 32 AT AZAMGARH AIRPORT

DATUM "WGS 84" (EGM 2008)

SCALE-1:5000

(FOR OFFICIAL USE OF AIRPORTS AUTHORITY OF INDIA ONLY)

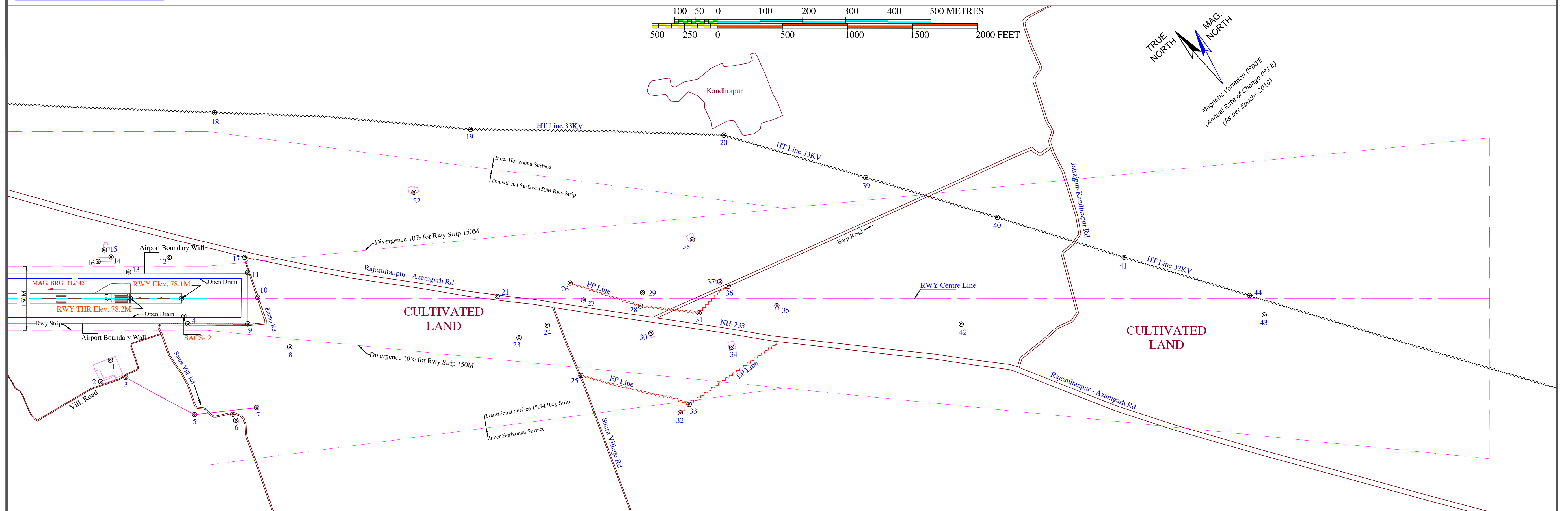

OBSTACLE TABLE FOR 150 M (500 FT.) RWY STRIP & IT'S FUNNEL

SL. NO.	OBJECT	WGS 84 CO-ORDINATES		TOP ELEV. (EGM 2008)	DISTANCE IN MTR.			W.R.T 1:30 IN APP.FUNNEL & 1:7 IN T.S.		W.R.T I.H.S./ CONICAL/O.H.S.		REMARKS
		LATITUDE "N"	LONGITUDE "E"		X	Y	YY	P.E. TOP ELEV.	OBST.	P.E. TOP ELEV.	OBST.	
1	TREE	26°09'04.50157"N	083°07'10.88175"E	86.7	-227	-145	-70	88.0	CLEAR	-	-	WITHIN T. S.
2	RAJIV GANDHI UNIVERSITY	26°09'03.81866"N	083°07'09.04720"E	84.7	-250	-195	-120	95.1	CLEAR	-	-	WITHIN T. S.
3	EP	26°09'02.74266"N	083°07'10.84384"E	82.9	-190	-185	-110	93.7	CLEAR	-	-	WITHIN T. S.
4	AIRPORT BOUNDARY WALL	26°09'02.52416"N	083°07'17.74082"E	79.6	-46	-60	-	78.0	1.6	-	-	WITHIN RWY STRIP
5	EP	26°08'57.13572"N	083°07'12.94630"E	82.6	-30	-272	-197	106.1	CLEAR	-	-	WITHIN T. S.
6	HOUSE	26°08'54.66745"N	083°07'15.16736"E	81.3	67	-285	-203	109.3	CLEAR	-	-	WITHIN T. S.
7	EP	26°08'54.29118"N	083°07'17.19020"E	83.1	116	-256	-169	106.1	CLEAR	-	-	WITHIN T. S.
8	HOUSE	26°08'55.95305"N	083°07'22.70043"E	79.6	193	-114	-20	87.4	CLEAR	-	-	WITHIN T. S.
9	AIRPORT BOUNDARY WALL	26°08'59.40662"N	083°07'21.44138"E	79.6	95	-60	-	81.3	CLEAR	-	-	WITHIN APP. FUNNEL
10	MOBILE ROAD TRAFFIC =(77.2+5) 82.2M	26°09'00.36946"N	083°07'23.56989"E	82.2	118	2	-	82.0	0.2	-	-	WITHIN APP. FUNNEL
11	AIRPORT BOUNDARY WALL	26°09'02.26384"N	083°07'24.37401"E	79.5	95	60	-	81.3	CLEAR	-	-	WITHIN APP. FUNNEL
12	TREE	26°09'07.16492"N	083°07'20.40639"E	84.7	-89	95	20	80.9	3.8	-	-	WITHIN T. S.
13	TREE	26°09'08.46509"N	083°07'17.05983"E	82.3	-184	61	-	78.0	4.3	-	-	WITHIN RWY STRIP
14	TREE	26°09'10.21232"N	083°07'16.83874"E	91.4	-225	96	21	81.0	10.4	-	-	WITHIN T. S.
15	HOUSE	26°09'10.94380"N	083°07'16.83269"E	84.9	-241	113	38	83.4	1.5	-	-	WITHIN T. S.
16	HOUSE	26°09'10.62632"N	083°07'15.78223"E	80.5	-255	86	11	79.6	0.9	-	-	WITHIN T. S.
17	MOBILE ROAD TRAFFIC =(78.2+5) 83.2M	26°09'03.27049"N	083°07'25.06474"E	83.2	88	96	12	82.7	0.5	-	-	WITHIN T. S.
18	HTL	26°09'12.87756"N	083°07'31.50192"E	100.3	17	434	357	-	-	124.3	CLEAR	WITHIN I. H. S.
19	HTL	26°08'58.69164"N	083°07'46.31586"E	99.0	616	395	258	-	-	124.3	CLEAR	WITHIN I. H. S.
20	HTL	26°08'45.24655"N	083°08'01.60781"E	100.8	1209	381	185	-	-	124.3	CLEAR	WITHIN I. H. S.
21	MOBILE ROAD TRAFFIC =(78.3+5) 83.3M	26°08'48.01712"N	083°07'38.38980"E	83.3	679	4	-	100.7	CLEAR	-	-	WITHIN APP. FUNNEL
22	HOUSE	26°08'58.12026"N	083°07'39.22130"E	80.2	484	248	125	112.1	CLEAR	-	-	WITHIN T. S.
23	TREE	26°08'44.59772"N	083°07'37.37541"E	87.3	730	-92	-	102.4	CLEAR	-	-	WITHIN APP. FUNNEL
24	HUT	26°08'43.83482"N	083°07'39.83182"E	80.4	796	-63	-	104.6	CLEAR	-	-	WITHIN APP. FUNNEL
25	EP	26°08'39.27740"N	083°07'39.01223"E	85.8	874	-181	-19	109.9	CLEAR	-	-	WITHIN T. S.
26	EP	26°08'44.98127"N	083°07'43.64631"E	84.8	849	35	-	106.4	CLEAR	-	-	WITHIN APP. FUNNEL
27	HOUSE	26°08'43.34626"N	083°07'43.50302"E	82.6	880	-4	-	107.4	CLEAR	-	-	WITHIN APP. FUNNEL
28	EP	26°08'40.06617"N	083°07'46.66230"E	86.6	1013	-18	-	111.9	CLEAR	-	-	WITHIN APP. FUNNEL
29	TREE	26°08'40.71045"N	083°07'47.57308"E	92.1	1018	13	-	112.0	CLEAR	-	-	WITHIN APP. FUNNEL
30	HOUSE	26°08'38.01767"N	083°07'45.74859"E	84.2	1038	-82	-	112.7	CLEAR	-	-	WITHIN APP. FUNNEL
31	EP	26°08'36.65966"N	083°07'49.89577"E	86.5	1151	-34	-	116.5	CLEAR	-	-	WITHIN APP. FUNNEL
32	EP	26°08'32.06664"N	083°07'43.00767"E	84.9	1107	-268	-83	-	-	124.3	CLEAR	WITHIN I. H. S.
33	EP	26°08'32.07045"N	083°07'44.03386"E	86.7	1128	-248	-61	-	-	124.3	CLEAR	WITHIN I. H. S.
34	HOUSE	26°08'33.04972"N	083°07'49.92480"E	85.3	1227	-115	-	119.0	CLEAR	-	-	WITHIN APP. FUNNEL
35	HOUSE	26°08'33.01898"N	083°07'55.10180"E	87.2	1333	-17	-	122.5	CLEAR	-	-	WITHIN APP. FUNNEL
36	EP	26°08'36.62550"N	083°07'53.22126"E	86.5	1219	28	-	118.7	CLEAR	-	-	WITHIN APP. FUNNEL
37	HOUSE	26°08'37.31483"N	083°07'52.94734"E	84.4	1199	39	-	118.1	CLEAR	-	-	WITHIN APP. FUNNEL
38	HOUSE	26°08'41.05953"N	083°07'53.66623"E	83.5	1135	137	-	115.9	CLEAR	-	-	WITHIN APP. FUNNEL
39	HTL	26°08'35.53430"N	083°08'07.92539"E	101.2	1541	282	52	-	-	124.3	CLEAR	WITHIN I. H. S.
40	HTL	26°08'26.51208"N	083°08'13.74828"E	101.5	1849	189	-	139.7	CLEAR	124.3	CLEAR	WITHIN APP. FUNNEL
41	HTL	26°08'17.72592"N	083°08'19.26852"E	101.5	2145	96	-	149.6	CLEAR	124.3	CLEAR	WITHIN APP. FUNNEL
42	MOBILE TOWER LT	26°08'22.45000"N	083°08'05.41000"E	123.4	1764	-60	-	136.9	CLEAR	124.3	CLEAR	WITHIN APP. FUNNEL
43	CHIMNEY	26°08'07.26856"N	083°08'24.61666"E	106.1	2473	-39	-	160.5	CLEAR	124.3	CLEAR	WITHIN APP. FUNNEL
44	HTL	26°08'09.10968"N	083°08'24.81108"E	100.5	2438	6	-	159.4	CLEAR	124.3	CLEAR	WITHIN APP. FUNNEL

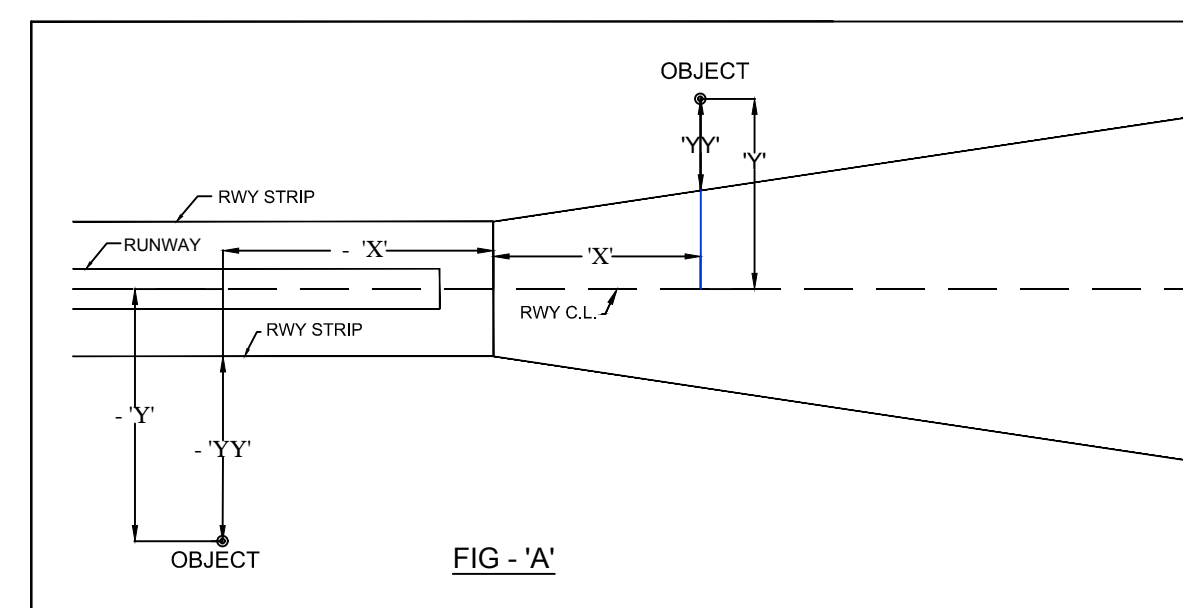

Notes:-

1. 'X' Denotes Longitudinal Distance from Rwy Strip to Object Along Centre Line of Rwy as shown in fig. 'A'
2. 'Y' Denotes Lateral Distance from the Extended Rwy Centre Line to Object as shown in fig. 'A'
3. 'YY' Denotes Lateral Distance from edge of Approach Funnel / Rwy Strip to Object as shown in fig. 'A'
4. 'O' Marked in column sr. no. denotes Object forming Obstacle and falling within Approach Funnel / Rwy Strip.
5. '□' Marked in column sr. no. denotes object forming obstacle and lying outside Approach Funnel / Rwy Strip.
6. All the Distances & Elevations are in Meter.
7. All Co-ordinates are in "WGS-84" System and Elevations are in EGM 2008.
8. Permissible Top Elev. in Approach Funnel Calculated With Permissible Slope of 1:30 up to 3000m.
9. Code- 3 B Non- Instruments

AMENDMENT RECORD		
No.	DATE	DESCRIPTION

ABBREVIATION
W.R.T - WITH REFERENCE TO
T.S. - TRANSITIONAL SURFACE
I.H.S. - INNER HORIZONTAL SURFACE
C.S. - CONICAL SURFACE
APP. - APPROACH
ELEV. - ELEVATION
EOR. - END OF RUNWAY

CLIENT:- AIRPORTS AUTHORITY OF INDIA

PROJECT:- OBSTACLE SURVEY OF AZAMGARH AIRPORT

TITLE:- APPROACH FUNNEL RWY 32

DRG NO:- AAI/AZAMGARH/APP/32/ MARCH 2018/DT. 25.03.18

SCALE:- 1:5000 DATE OF SURVEY MARCH 2018

CONSULTANTS:- **AERO SURVEY PVT. LTD.**
NEW DELHI-110016